

County Line & I-25 Road Improvement Project

Phase 2A Construction June 2018-November 2018
Thank you for your patience!

For more information visit CityofLoneTree.com/CountyLineImprovements

Project Highlights:

- 1 Widen Park Meadows Center Drive to include three northbound lanes to accommodate the I-25 southbound ramp, the I-25 northbound ramp, and eastbound County Line Road.
- 2 Add a second left turn lane from westbound County Line Road into Park Meadows Retail Resort.
- 3 Widened off ramp from southbound I-25 onto County Line Road to add a westbound right turn lane.

Additionally, the project will put a new asphalt overlay on County Line Road between Chester Street & I-25 and include storm sewer improvements.

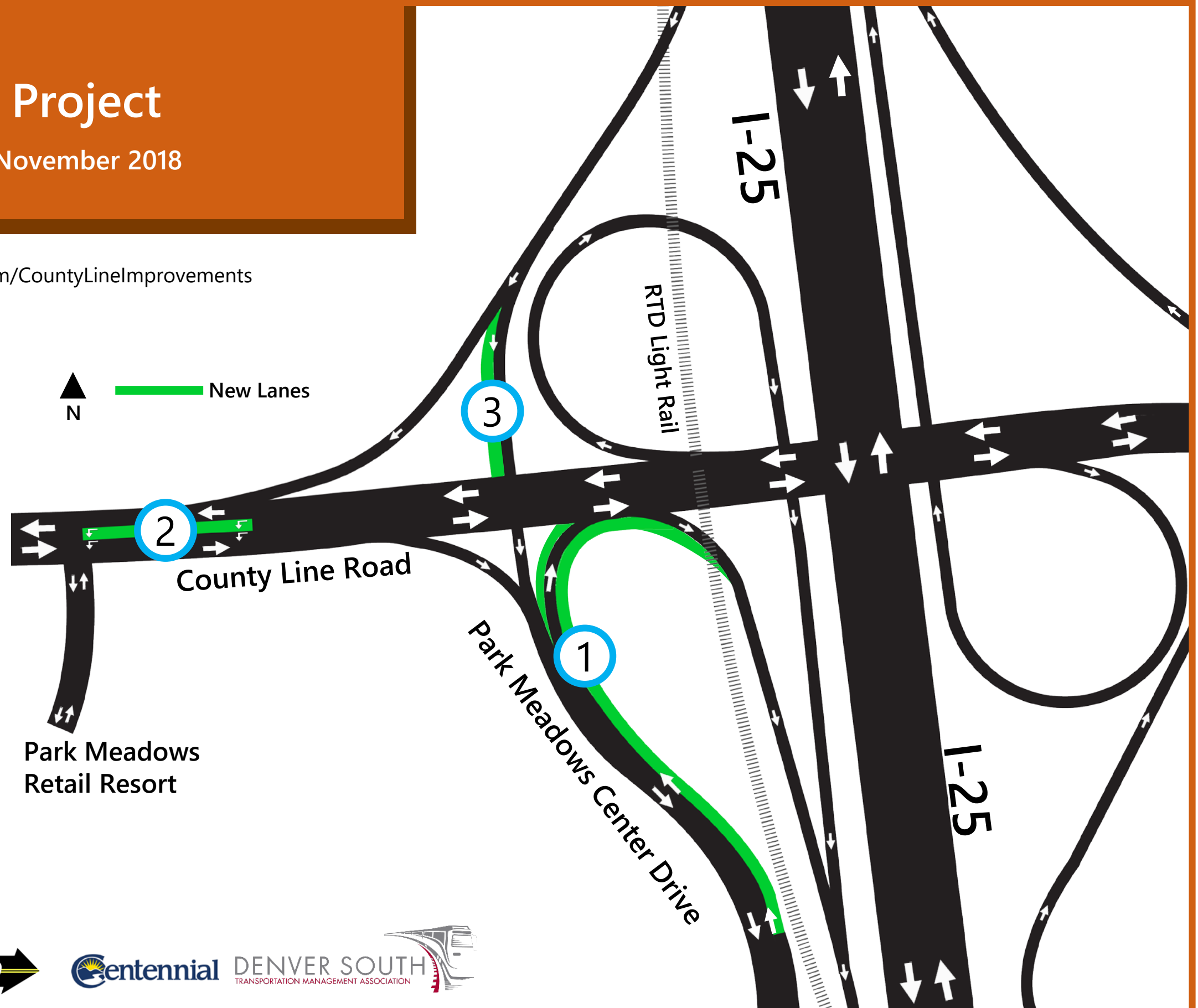

Thank You To Our Project Partners:

